



PATINA  
CATERING  
AT ROCKEFELLER CENTER



# PATINA

CATERING  
AT ROCKEFELLER CENTER



Overview . . . . .	3
Complete Venue . . . . .	4
The Sea Grill . . . . .	6
Rock Center Café . . . . .	8
Summer Garden & Bar . . . . .	10
The Rink at Rockefeller Center . . . . .	12
Contact Information . . . . .	13

Whether you're planning an elegant multi-course dinner for ten in one of our private dining rooms, or a gala reception for 2,000 in view of the gilded Prometheus statue, **Patina Catering at Rockefeller Center** offers

- **The ultimate iconic New York City venue**
- **A customized menu created for you by the accomplished chefs of the award-winning Patina Restaurant Group**
- **Personalized attention from our Events team, with decades of experience creating magical events in a landmark location**
- **A convenient location in the heart of midtown Manhattan**
- **Access to the world's most famous ice skating rink in the winter, and midtown's largest outdoor dining space in the summer**







## ROCKEFELLER CENTER

With access to over 7,000 square feet indoors, as well as 7,200 square feet of outdoor space, Patina Catering at Rockefeller Center offers the opportunity to host impressive, large-scale events of up to 2,000 guests in the heart of midtown Manhattan

Rockefeller Center is an iconic destination year round, and when the Christmas Tree arrives in November, there is no more magical place in New York to celebrate the holidays.

### CAPACITIES

Cocktail Reception:  
up to 2,000 guests

Reception/Stations:  
1,200 - 1,500 guests



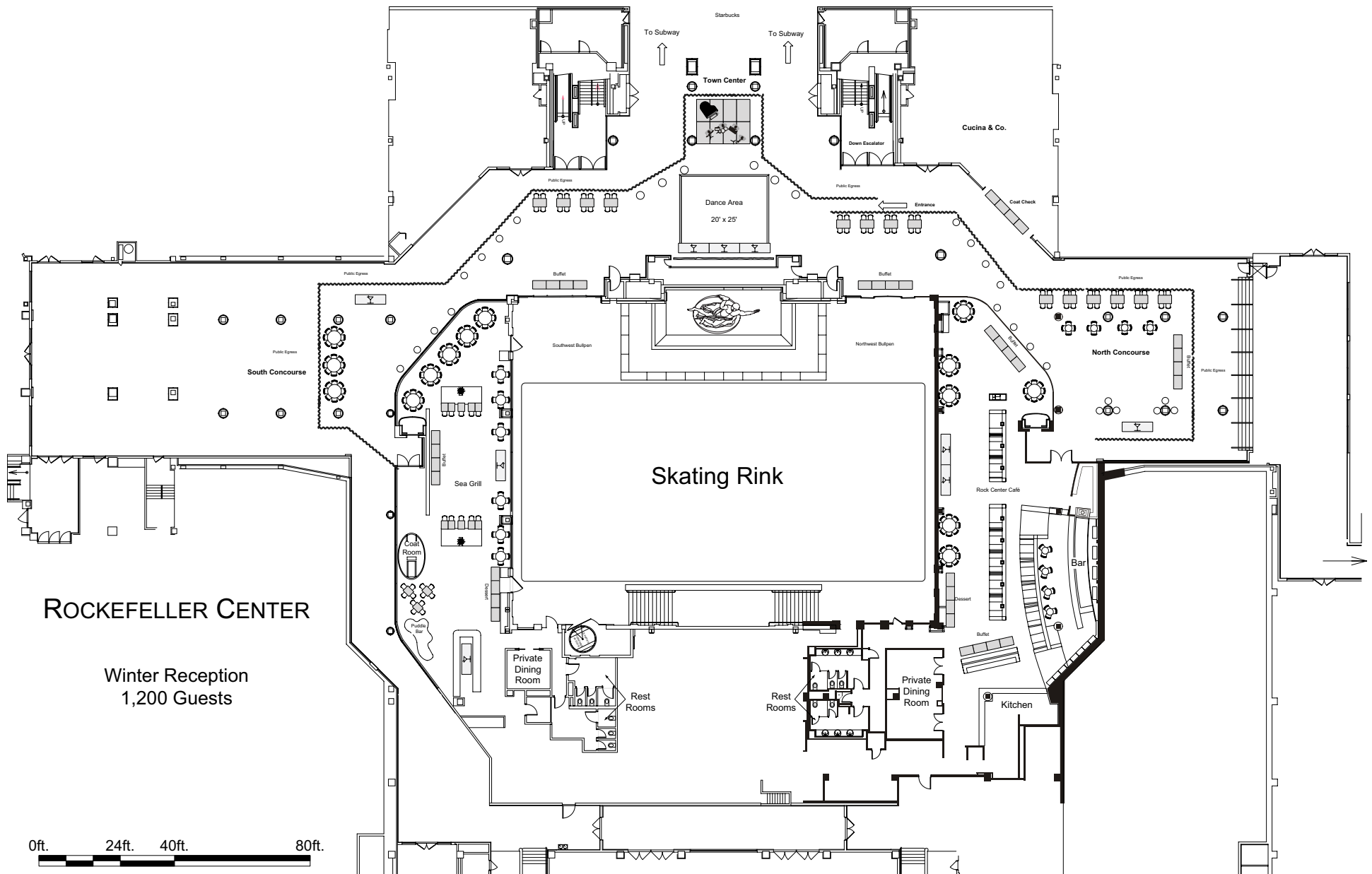

## 5 | COMPLETE VENUE FLOOR PLAN





# The Sea Grill

The spacious and elegant interior of The Sea Grill, designed by world-famous restaurant designer Adam Tihany, offers guests impressive year-round views overlooking The Rink at Rockefeller Center in winter and our lush, flowering Summer Garden in the warmer months.



## CAPACITIES

Cocktail Reception:  
up to 250 guests

Reception/Seated Dinner:  
120 - 150 guests

Private Room:  
8 - 14 guests

# THE SEA GRILL

Reception And Seated Dinner For 130

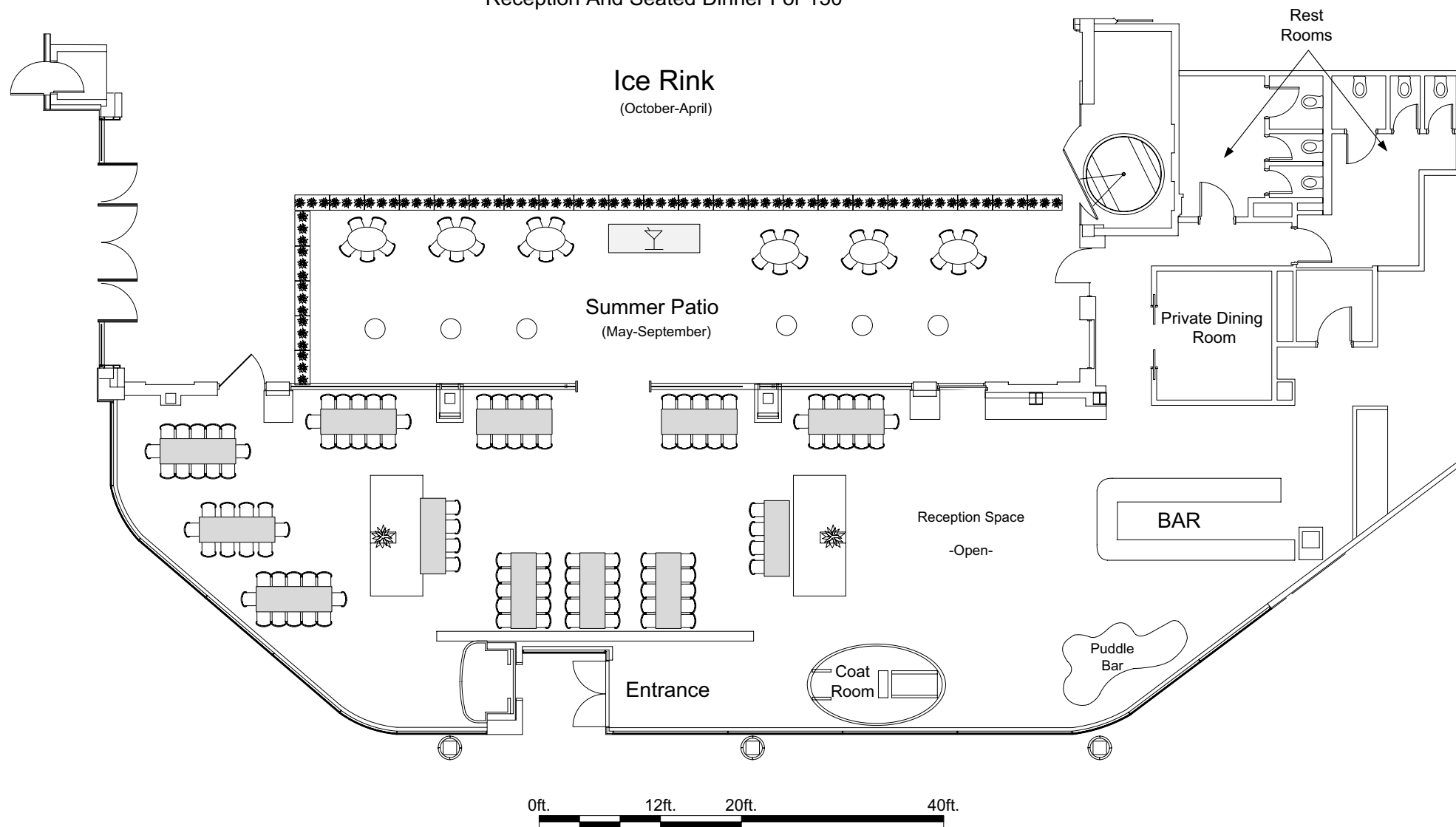



# ROCK CENTER CAFÉ

Rock Center Cafe offers classic New York City ambiance, with a series of original prints by the great American artist Andy Warhol, and stunning views of the gilded Prometheus statue, overlooking the Rink from October - April, and our Summer Garden & Bar from May - September.



## CAPACITIES

Cocktail Reception:  
up to 250 guests

Reception/Stations:  
250 - 550 guests

Private Room:  
Up to 30 guests



# ROCK CENTER CAFÉ

Reception For 300 Guests

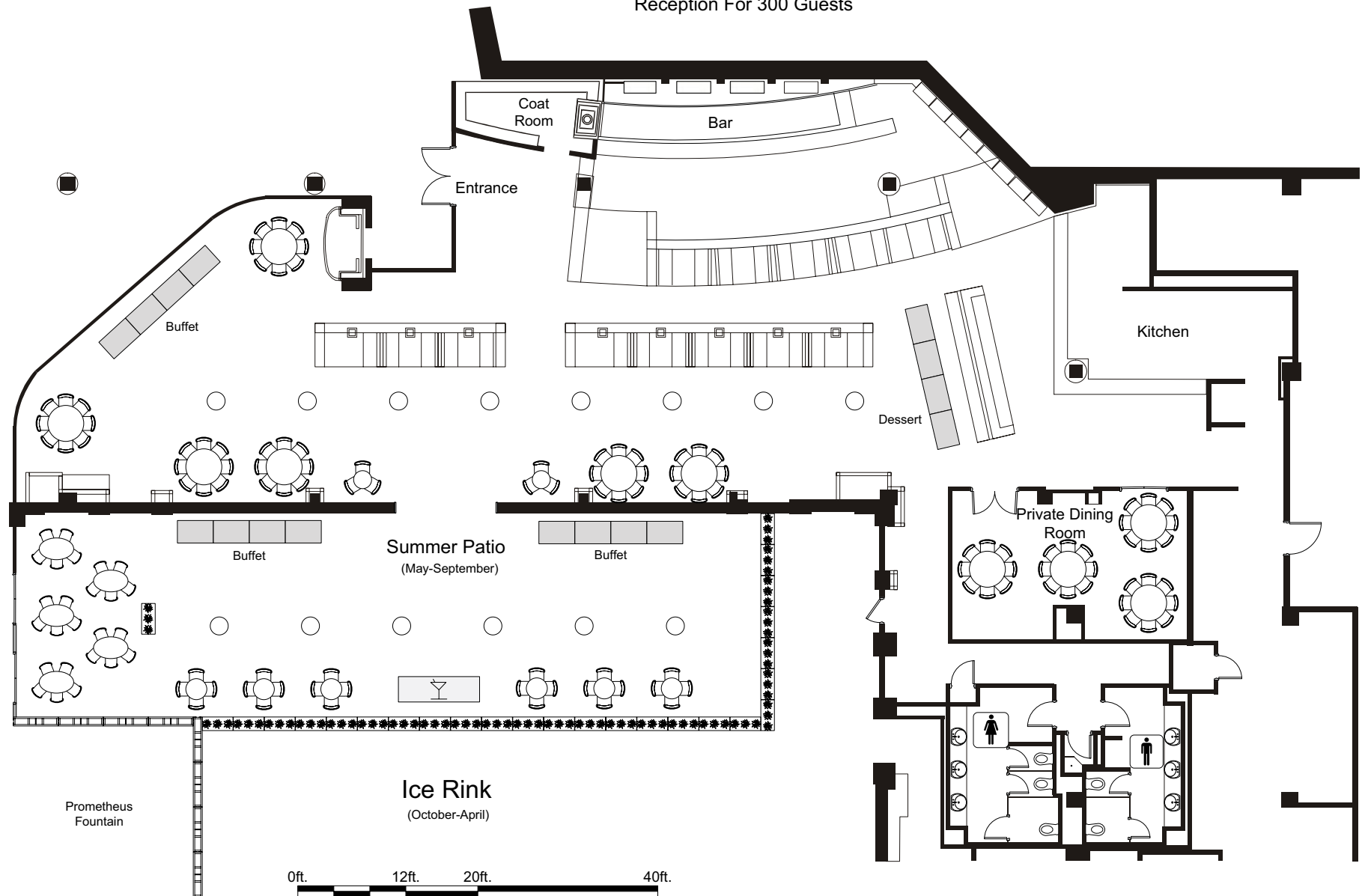

## 9 | ROCK CENTER CAFÉ FLOOR PLAN



## SUMMER GARDEN & BAR

— ROCK CENTER CAFÉ —

Open May - September, the Summer Garden & Bar at Rock Center Cafe is a rare oasis in the middle of the city. With over 7,200 feet of outdoor space and endlessly flexible floorplans, there's no better place to host summer cocktail parties, gala receptions - or a barbecue party for 400 of your closest friends.

### CAPACITIES

Cocktail Reception:  
up to 2,000 guests

Reception/Stations:  
1,200 - 1,500 guests





# ROCKEFELLER CENTER

Summer Reception For 1,200

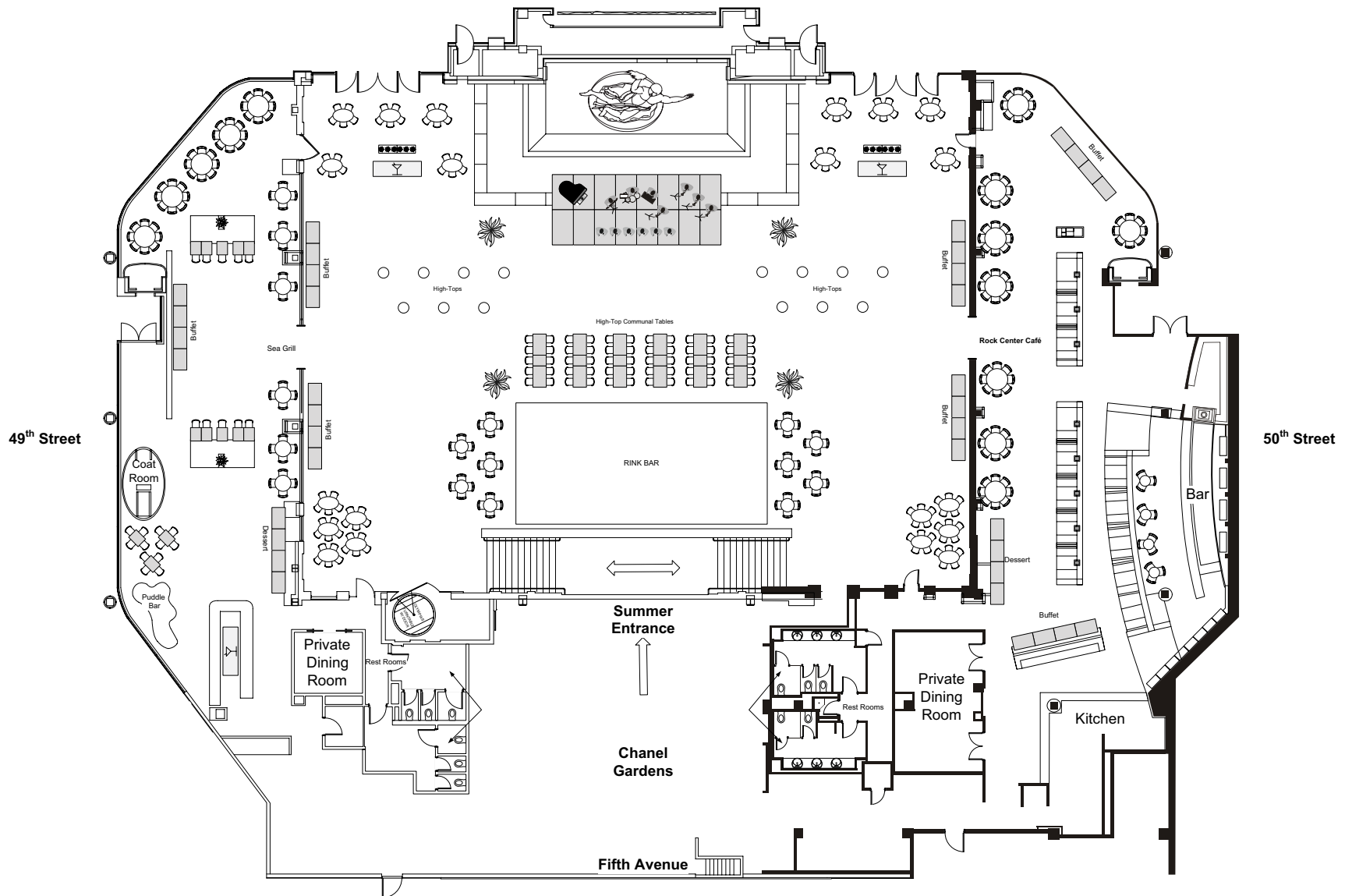



## THE RINK ROCKEFELLER CENTER

The Rink at Rockefeller Center is a beloved New York City landmark that has been a quintessential Manhattan experience for over 80 years. During the holidays, Rockefeller Center's sparkling lights and Christmas tree create a truly unique festive atmosphere.

Open October - April, you can place this iconic space at the center of your next event:

- Add ice skating to your event, guaranteeing a memorable experience for your guests.
- Carpet the ice and transform the space into a winter wonderland







## THANK YOU!

We look forward to welcoming you.  
For more information, please contact:

**Patina Catering at Rockefeller Center  
Events Team**

**Phone: 212 332 7606**

**Fax: 212 370 7677**

**Ken Palmer**  
[kpalmer@patinagroup.com](mailto:kpalmer@patinagroup.com)

**Jeffrey Keltz**  
[jkeltz@patinagroup.com](mailto:jkeltz@patinagroup.com)